

Removal

1. Drain the brake fluid from the modulator tank.
2. Drain the high pressure brake hose (page 13-26).
3. Disconnect the inlet hose.
4. Remove the reservoir strainer.
5. Remove the 5 mm screws and remove the reservoir.
6. Screw the 6 mm bolt into the threaded hole in the center of the solenoid head, raise the solenoid head parallel to the ground and remove it.
7. Remove the solenoid cover.
8. Remove the hexagonal socket screws and loosen the solenoid set plate.
9. Turn the solenoid valves several times until they move freely and turn the solenoid valves 1/2 turn to align their projection with the cutout in the set plate. Remove the solenoid valves together with the set plate.

CAUTION: The solenoid valves are delicate parts. Be careful not to drop them.

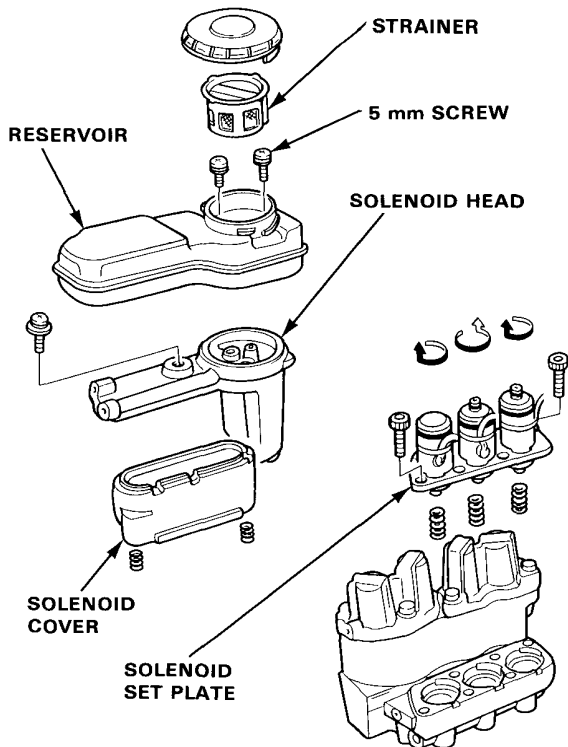

Inspection

1. Connect a tube to the inlet of the solenoid valve. Apply compressed air to the solenoid valve through the tube.
2. Check the solenoid valve for proper operation by connecting a 12 V fully charged battery to the 3-P coupler terminals:

Voltage not applied: There should be no air flow.

BLK — RED: There should be air flow through IN and OUT.

Black-Red : There should be air flow through IN. and Black-Yellow

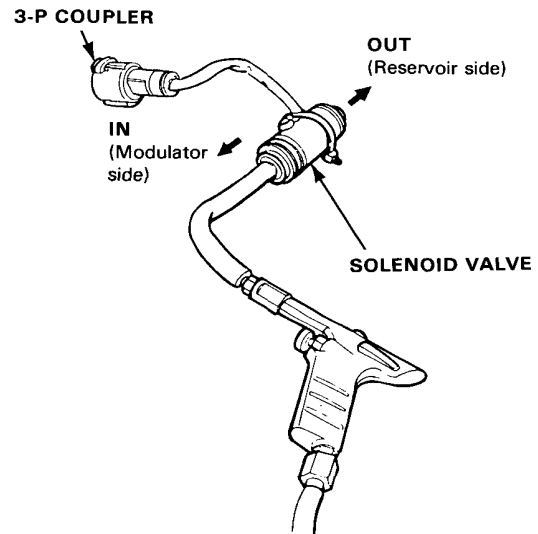

REAR SOLENOID

FRONT SOLENOID

