

Electronic Components

Control Unit Replacement

Remove the control unit cover and attaching bolts, then remove the control unit.

CAUTION:

- If the control unit attaching bolts are removed, the control unit's memory is cleared.
- Handle the control unit with care.

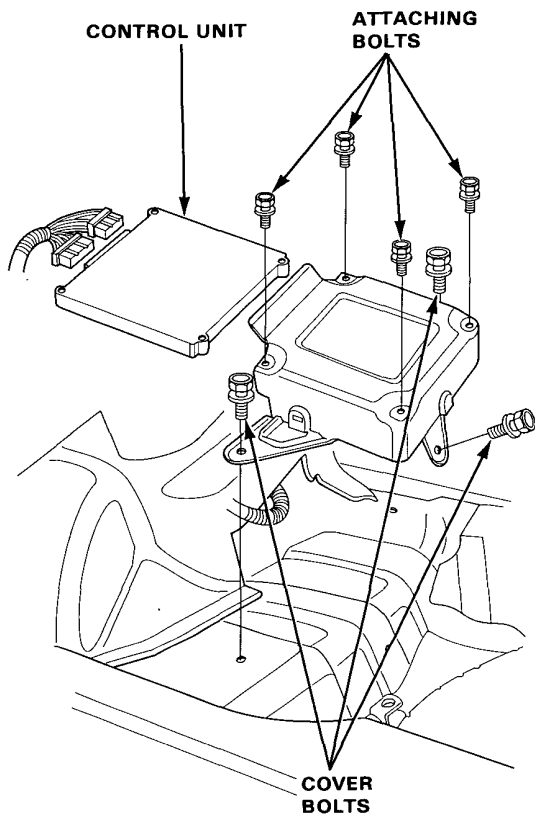

Installation is the reverse order of removal.

NOTE: Check the dash warning light function by turning the ignition switch ON.

Fail Safe Relays/Motor Relay Inspection

1. Check for continuity between terminals A and B.
There should be no continuity.
2. Connect a 12 V battery across terminals C and D.
There should be continuity between terminals A and B.

