

Gearbox

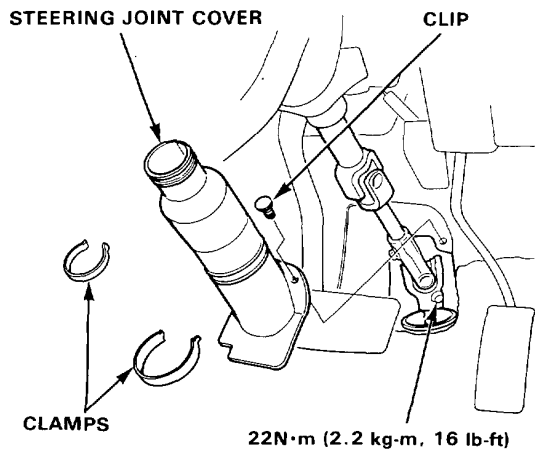

Removal/Installation

1. Remove the cover panel and steering joint cover, then disconnect the steering shaft from the gearbox.



2. Raise the front of car on jack stands and remove the front wheels.
3. Remove the cotter pins, and unscrew the tie-rod end ball joint nuts halfway.
4. Break the ball joints loose using the ball joint remover.
5. Then remove the nuts, and lift the tie-rod ends out of the steering knuckles.

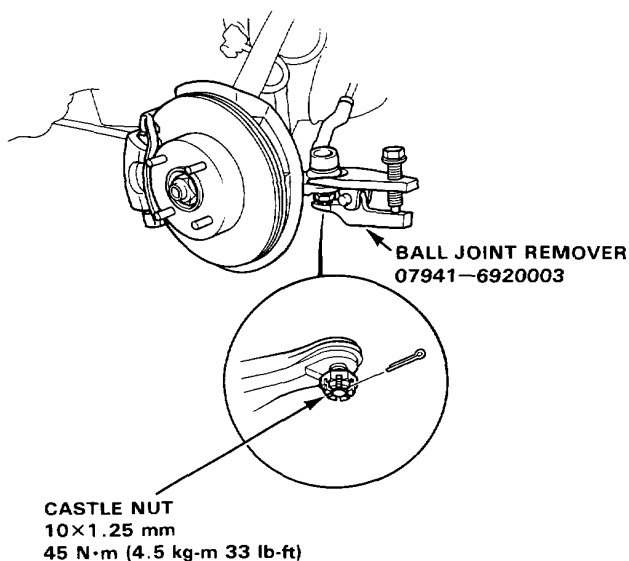

6. Disconnect the shift lever torque rod from the clutch housing.

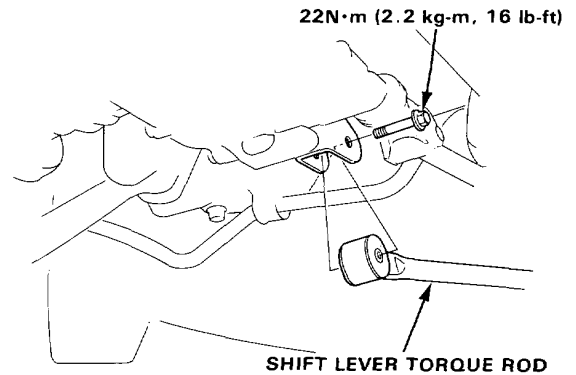

7. Remove the pin retainer, drive out spring pin with punch, then disconnect the shift rod.

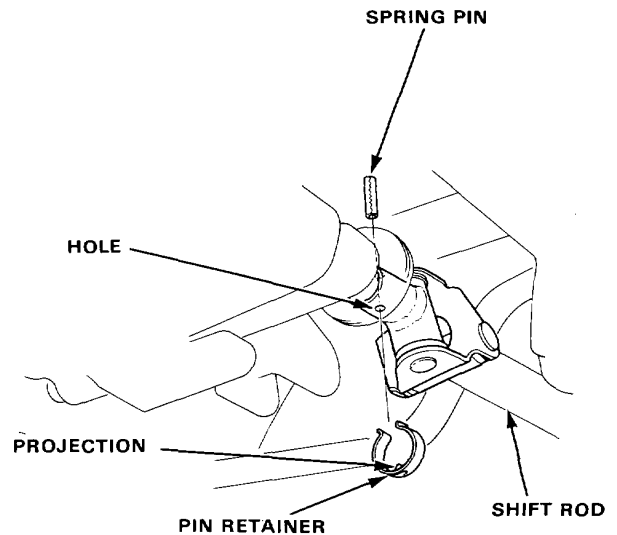

NOTE: On reassembly, reinstall the pin retainer after driving in pin and be sure that the projection on the pin retainer is in the hole.

(cont'd)

Gearbox

Removal/Inspection (cont'd)

8. Remove the self-locking nuts connecting exhaust header pipe to exhaust pipe B, then separate exhaust pipe B from the header pipe.

CAUTION: Replace the exhaust gasket and self-locking nuts when you reinstall the pipe.

9. Remove the header pipe.

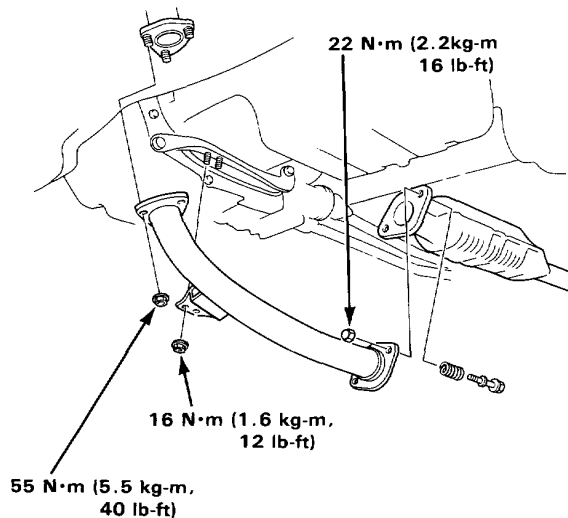

10. Remove the steering gearbox brackets.

11. Remove the steering gearbox mounting bolts.

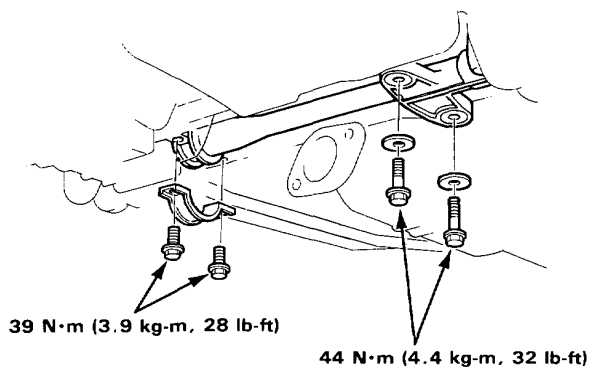

12. Slide tie rod all the way to the right side.

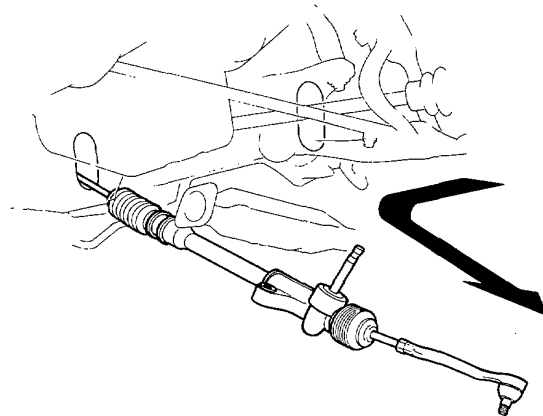

13. Slide the gear box right so that the left tie rod clears the bottom of the rear beam, then remove the gearbox.

14. Re-install is in the reverse order of removal.