

Carpet/Door Sill Moldings

Replacement

1. Remove:
 - Front seats (page 14-46).
 - Security compartment (page 14-52).
 - Center console (page 14-53).
 - Hood release handle.
 - Fuel filler door and tailgate openers.
 - Front of quarter trim panel.
2. Pry out the clips and pull up the door sill moldings.
3. Remove the push nuts, then separate the door sill moldings and carpet.
4. Pry out the clips at the rear edge and under the dashboard, peel off the tape and remove the clip nuts.

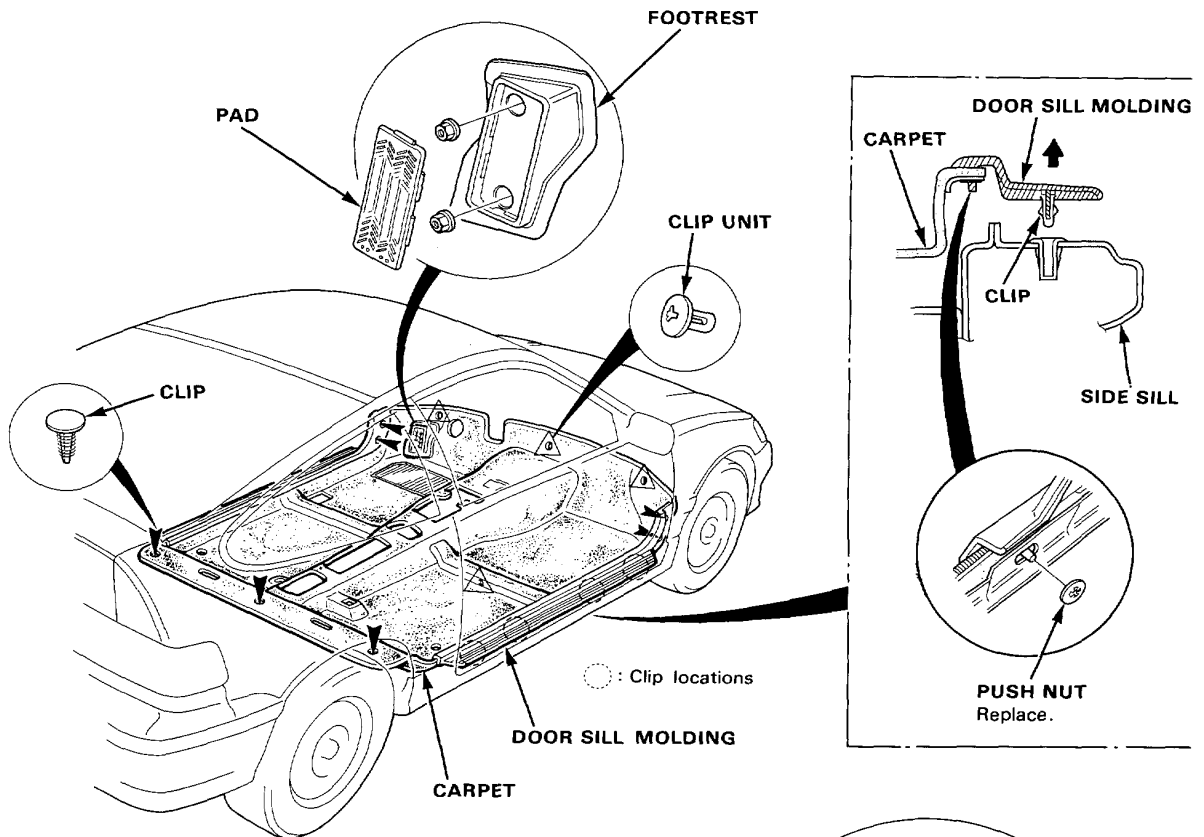

5. Cut the (A) area first, then pull back the carpet as shown.
6. Remove the carpet.
7. Install the carpet in the reverse order of removal.

NOTE:

- Reattach the cut areas with tape and tie bands.