

Heater Control Cables

Air Mix Cable Adjustment

1. Slide the temperature control lever to HOT.
2. Turn the air mix door shaft arm to the left and connect the end of the cable to the arm.
3. Gently slide the cable outer housing back from end enough to take up any slack in the cable, but not enough to make temperature control lever move, then snap the cable housing into the clamp.

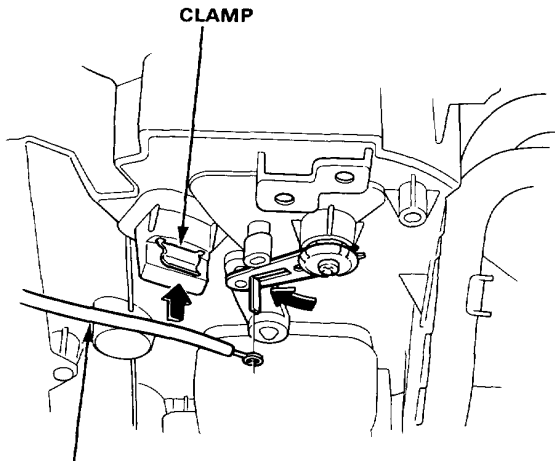

AIR MIX CABLE

NOTE: Heater valve cable should be adjusted if the air mix cable has been disconnected.

Heater Valve Cable Adjustment

1. Slide the temperature control lever to HOT.
2. Gently slide the cable housing back from end enough to take up any slack in the cable, but not enough to make the temperature control lever move, then hold the cable housing and snap it in the clamp.

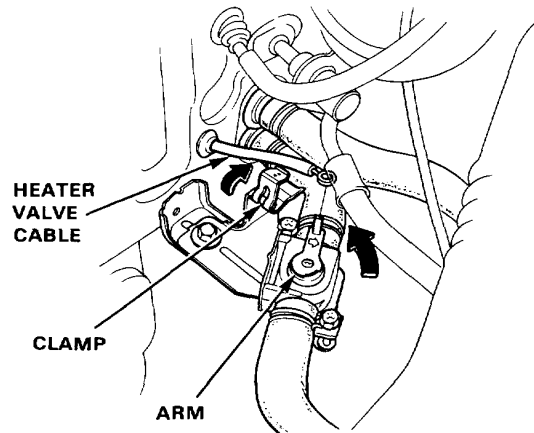

NOTE: Air mix cable should be adjusted if the heater valve cable has been disconnected.