

Emission Control System

Tailpipe Emission

Inspection

WARNING Do not smoke during this procedure. Keep any open flame away from your work area.

1. Start the engine and warm up to normal operating temperature (cooling fan comes on).
2. Connect tachometer.
3. Check idle speed and adjust the idle speed, if necessary (page 6-69).
4. Warm up and calibrate the CO meter according to the meter manufacturer's instructions.
5. Check idle CO with the headlights, heater blower, rear window defogger, cooling fan, and air conditioner off.

Specified CO%:

With CATA: 0.1% maximum

Without CATA: $1.0 \pm 1.0\%$

- If unable to obtain this reading:
On With CATA, see ECU troubleshooting (page 6-14 or 16).
On other models, adjust by turning the adjusting screw of the IMA sensor.

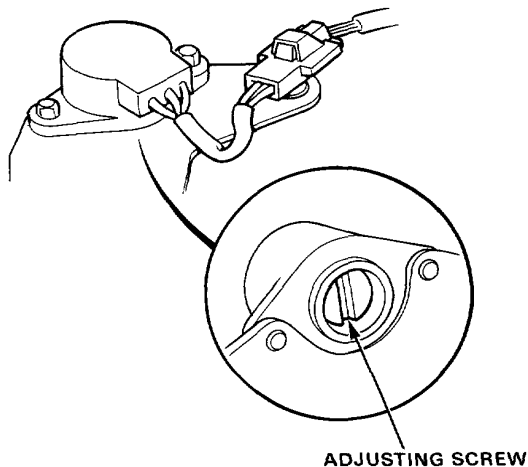

- If unable to obtain a CO reading of specified % by this procedure, check the engine tune-up condition.

Positive Crankcase Ventilation System

Inspection

1. Check the crankcase ventilation hoses and connections for leaks and clogging.

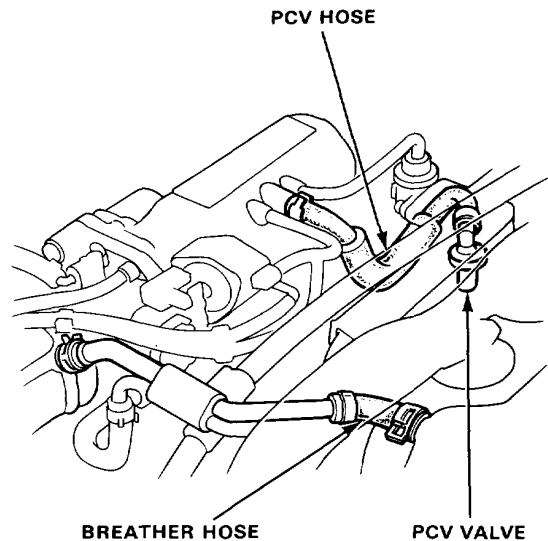

2. At idling, make sure there is a clicking sound from the PCV valve when the hose between PCV valve and intake manifold is lightly pinched with your fingers or pliers.

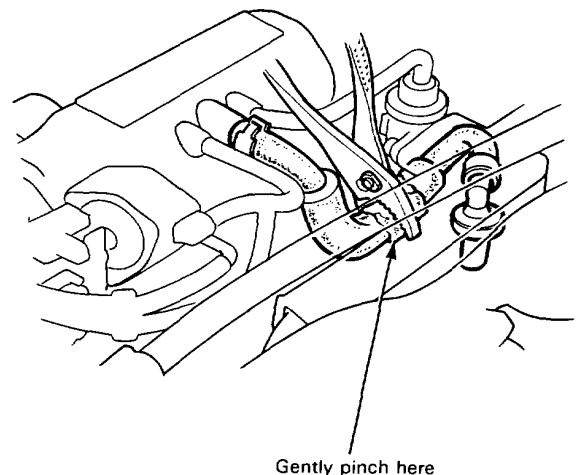

- If there is no clicking sound, check the PCV valve grommet for cracks or damage. If the grommet is OK, replace the PCV valve and recheck.