

Reassembly

1. Install a new O-ring on the pump motor.
2. Coat the O-ring with clean brake fluid and install the pump assembly on the motor while rotating it right and left by hand.

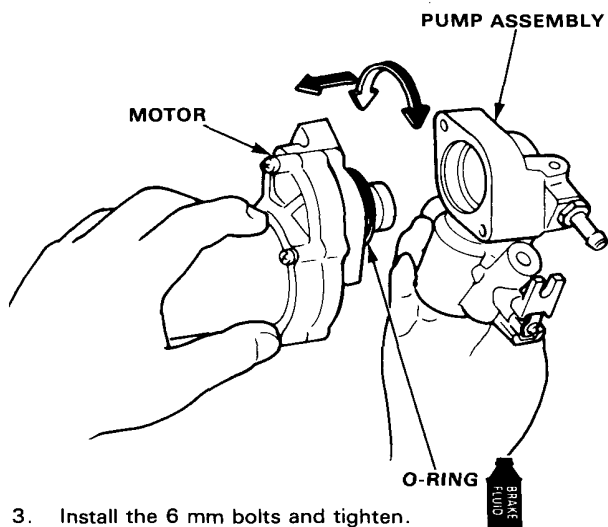

3. Install the 6 mm bolts and tighten.
4. Place the motor in a vise as shown and tighten the outlet plug.

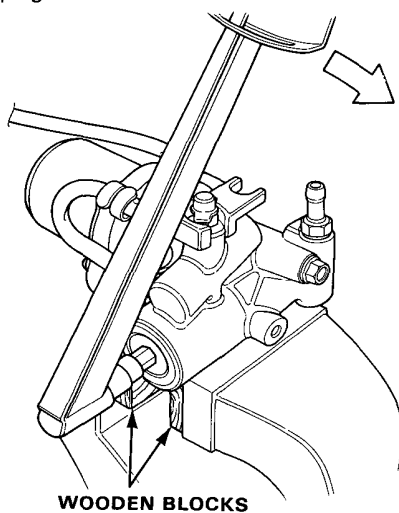

NOTE: Clamp the pump in a vise only as shown above.

9. Install the pump bracket.

